

DTH

FEMALE NPT BRANCH TEE

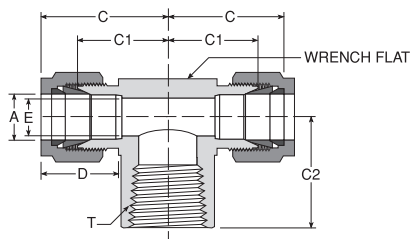
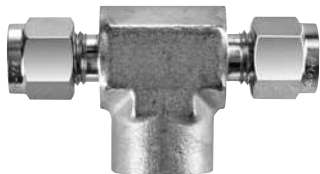

PART No.	A Tube OD	Hex Tube Nut	D	T NPT	E Min Orifice	C	C1	C2	Wrench Flat
DTH-2-2-*	1/8"	7/16"	0.60	1/8"	0.09	0.96	0.70	0.75	5/8"
DTH-4-2-*	1/4"	9/16"	0.70	1/8"	0.19	1.05	0.76	0.75	5/8"
DTH-4-4-*	1/4"	9/16"	0.70	1/4"	0.19	1.17	0.88	0.88	13/16"
DTH-6-4-*	3/8"	11/16"	0.76	1/4"	0.28	1.23	0.94	0.88	13/16"
DTH-6-6-*	3/8"	11/16"	0.76	3/8"	0.28	1.32	1.02	0.88	15/16"
DTH-8-4-*	1/2"	7/8"	0.86	1/4"	0.41	1.40	0.99	0.88	13/16"
DTH-8-6-*	1/2"	7/8"	0.86	3/8"	0.41	1.43	1.02	0.88	15/16"
DTH-8-8-*	1/2"	7/8"	0.86	1/2"	0.41	1.53	1.12	1.12	1 1/16"
DTH-8-12-*	1/2"	7/8"	0.86	3/4"	0.41	1.66	1.25	1.25	1 5/16"
DTH-10-8-*	5/8"	1"	0.86	1/2"	0.50	1.52	1.12	1.12	1 1/16"
DTH-12-12-*	3/4"	1 1/8"	0.86	3/4"	0.62	1.66	1.25	1.25	1 5/16"
DTH-14-12-*	7/8"	1 1/4"	0.86	3/4"	0.72	1.68	1.28	1.25	1 5/16"

* Add Suffix "SS" for 316 Stainless Steel or "B" for Brass.

DTI

TUBE INSERT

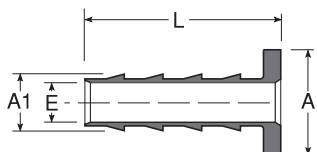

Used with soft polymer tubing

PART No.	A Tube OD	A1 Tube ID	E Min Orifice	L OAL
DTI-3-2-*	3/16"	1/8"	0.09	0.47
DTI-4-2-*	1/4"	1/8"	0.09	0.47
DTI-4-3-*	1/4"	3/16"	0.14	0.47
DTI-5-4-*	5/16"	1/4"	0.12	0.56
DTI-6-3-*	3/8"	3/16"	0.12	0.56
DTI-6-4-*	3/8"	1/4"	0.19	0.56
DTI-8-6-*	1/2"	3/8"	0.31	0.75
DTI-10-8-*	5/8"	1/2"	0.44	0.86
DTI-16-12-*	1"	3/4"	0.69	0.94

* Add Suffix "SS" for 316 Stainless Steel or "B" for Brass.

Dimensions are provided in inches and are for reference only, subject to change. Dimensions shown are with the nut in the